

The world's favorite lock



Euro Profile Cylinders



Euro Profile Cylinders

Y series cylinder, a high security Euro-profile 6-pin dimple cylinder with premium keys of nickel plate finish is designed for commercial applications

Features and Specifications

Specification

- Y Series cylinder conform to EN 1303:2005

Master Key System

- Maximum up to 4 levels of master keying system
- Construction master keying option

Key way

- Varies keyways design to suit high security applications

Cylinder Length

- Cylinder and turn 35 x 35 mm
 - Single cylinder 45mm (35 x 10mm)
 - Double cylinder 35 x 35mm (5mm increment)
- * Other dimensions are available upon request

Cam

- Profile cylinders are supplied with the cams in the standard position (25° approximately)

Dimple Key

- Symmetric design of key biting, non-directional cylinder operation



Product Description

Yale range of Euro Profile Fixed Cam Cylinders suitable to be used with Euro Profile Mortise Locks

Application

Cylinders to suit Euro Profile & DIN: ISO 12209 Mortise Locksets.

Keying

6 pin Yale keyway cylinders, optionally incorporate with master keying system.

Cylinder Options

- Cylinder and Turn, fixed cam, 70mm length
- Double Cylinder, fixed cam, 70mm length.
- Single Cylinder, fixed cam, 45mm length.
- Privacy Cylinder, fixed cam, 70mm length

Euro Profile Cylinders

Cylinders

Yale cylinders are available within a choice of keying systems to meet the degree of security desired for the facility requirements.

Cylinders are normally supplied with three keys. All other keys, such as master keys, control keys and construction keys must be specified as separate items.

Keyway

Unique key way design to meet most sophisticated situations and applications.

The dimple cylinder is highly recommended and perfect solution for commercial and high end residential applications.

Master Keying

Master key system can be very useful for operating convenience to control a building, group of buildings, floors of a building, or even sections of a floor. When particularly large groups of doors are involved, a master key system is almost a necessity for safety and security control.

Level of control

In general, 3 level of master keying system is most common while Y series cylinder offers the master keying system up to maximum 4 levels of control. This is normally more than enough to handle any job.

Choosing the proper level of control is extremely important since it involves making the basic decision in master keying: weighing the Security-vs.-convenience trade-off. Although more levels of keying are convenient, if too many are used, security begins to suffer.

Master Key System Hierarchy

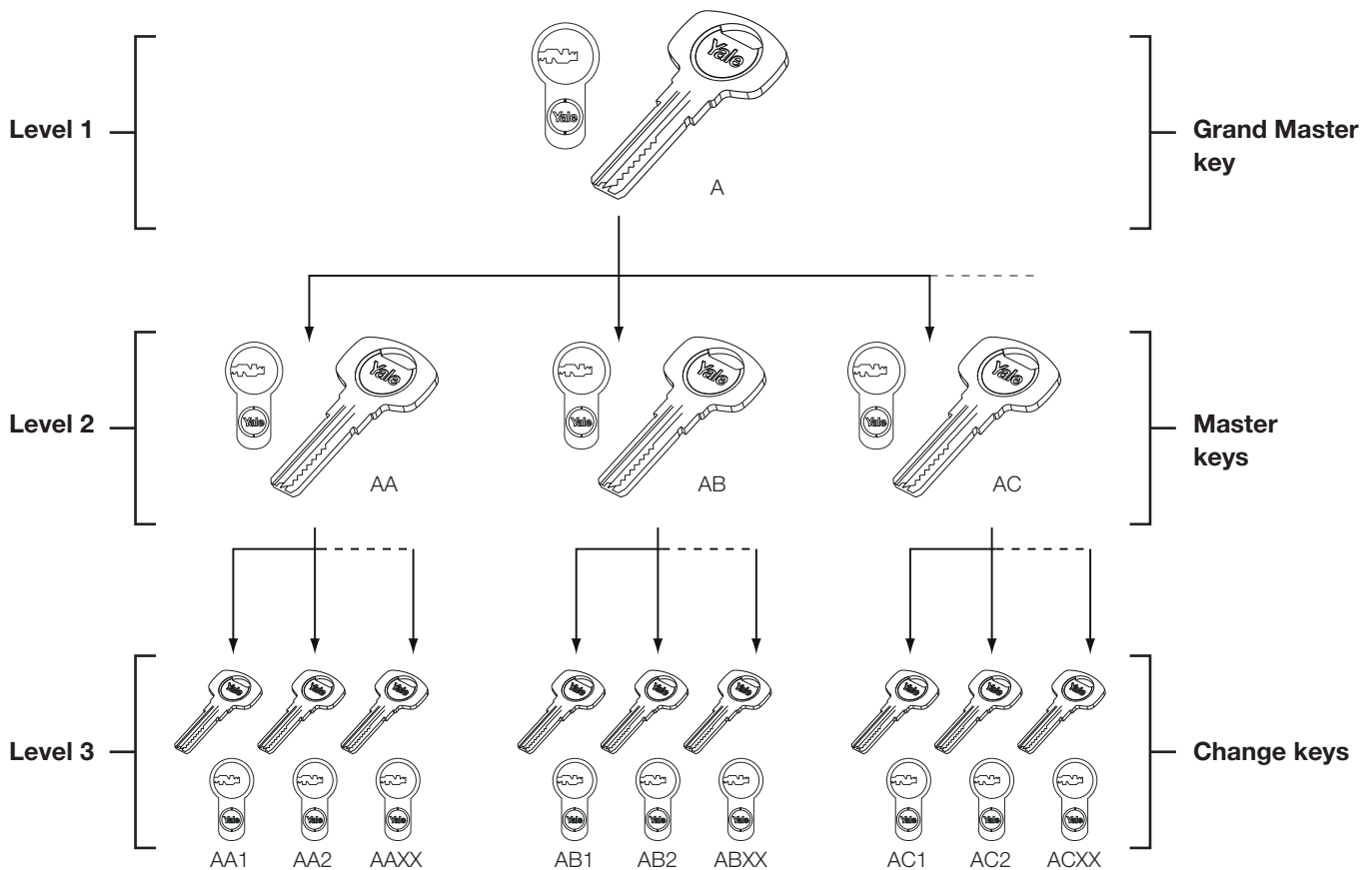

Euro Profile Cylinders

Cylinder and Turn

Model No:
Y70/CT

Part Description:
6 Pin Cylinder and Thumbturn,
fixed cam, 70mm cylinder length.

Finish:
Satin Nickel – US15
Polish Brass – US3



Ordering No.	Cylinder Length	Finish
Y70/CT	Overall Length:70mm Case Length 35 / 35	Satin Nickel – US15 Polish Brass – US3

Other sizes 60mm, 80mm, 90mm, 100mm are also available.

Limiting Dimensions

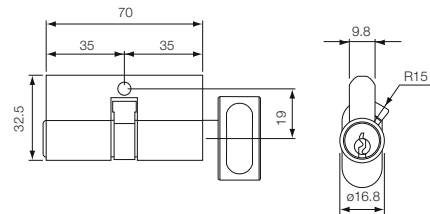

Double Cylinder

Model No:
Y70/DC

Part Description:
6 Pin Double Cylinder,
fixed cam, 70mm cylinder length.

Finish:
Satin Nickel – US15
Polish Brass – US3



Ordering No.	Cylinder Length	Finish
Y70/DC	Overall Length:70mm Case Length 35 / 35	Satin Nickel – US15 Polish Brass – US3

Other sizes 60mm, 80mm, 90mm, 100mm are also available.

Limiting Dimensions

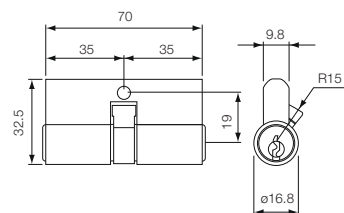

Euro Profile Cylinders

Cylinder Options

Single Cylinder

Model No:
Y45/SC

Part Description:
6 Pin Single Cylinder,
fixed cam, 45mm cylinder length.

Finish:
Satin Nickel – US15
Polish Brass – US3



Ordering No.	Cylinder Length	Finish
Y45/SC	Overall Length:45mm Case Length 35 / 10	Satin Nickel – US15 Polish Brass – US3

Limiting Dimensions

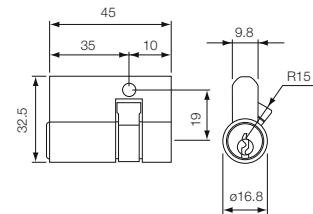

Privacy Cylinder

Model No:
Y70/PC

Part Description:
Privacy (Bathroom) Cylinder,
fixed cam, 70mm cylinder length.

Finish:
Satin Nickel – SN
Polish Brass – PB



Ordering No.	Cylinder Length	Finish
Y70/PC	Overall Length:70mm Case Length 35 / 35	Satin Nickel – US15 Polish Brass – US3

Other sizes 60mm, 80mm, 90mm, 100mm are also available.

Limiting Dimensions

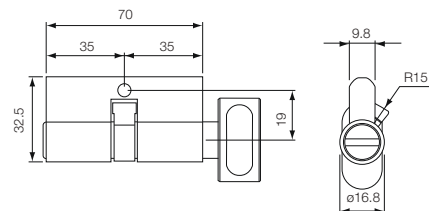

Euro Profile Cylinders

How to order Yale Key Systems

Procedures

1. To ensure prompt and accurate processing, purchase orders should be written in schedule or keying system requirement using the key symbols to describe each master keyed item. Standard key code will be assigned unless other specified.
2. Yale key code will be marked on key bow based on Standard Key coding System

New or Existing Systems

Indicate system expansion in terms of estimated numbers of key combinations, not doors or in terms of percentages. All of this information is essential at the inception of a keying system in order for Yale to ensure accommodation of the end user's present and future needs.

Advise as follows:

- How many levels of keying?
- Plan for a construction master key?
- Any selective master keys, such as ENG?
- How many changes for each master?
- Which masters or grands have high security cylinders under them?

Standard Key Coding

Single Key

If the cylinder is to be operated by its change key and nothing lower 2 Level System 3 Level System than the single-lettered GMK, the change number is added to the GMK symbol. This is illustrated by the example A1 in the schematic shown. When locks are required which are not operated by ANY master keys or other change keys in the system, they are referred to as "single keyed" and given symbols SKD1, SKD2, etc.

2 Levels of Keying

The master key symbol consists of Two letters, such as AA. The change key numbers are added to the master key letters. The numbers come FIRST: 1AA, 2AA, 3AA, etc.

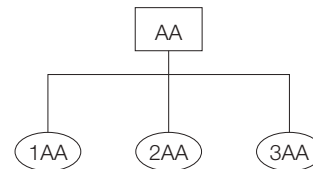

3 Levels of Keying

The grand master is assigned any One letter, such as A. The master keys under this grand are assigned Two letters, the first of which must be the same as the grand: AA, AB, AC, etc. are all masters under grand A. Masters BA, BB, BC, etc. are all under grand B. Caution: Do not use the letters I or O or Q because of possible confusion with the numerals 1 and 0, respectively. Change key numbers come after the letters, e.g., AA1, AA2, AA3, etc.

For master keys beyond AZ, insert a numeral between the letters to designate which pass through the alphabet they represent. A2A through A2Z represents the second pass of masters under grand A.

A3A, through A3Z would be the third. Change keys under these masters have the numbers suffixed in the usual way A2A1, A2A50, etc.

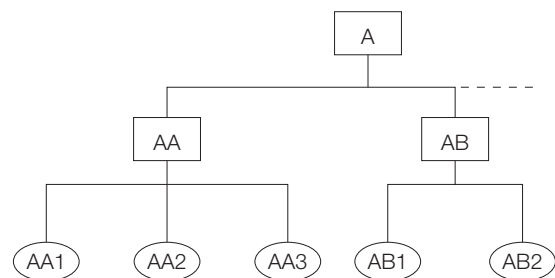

Specification Service

For all Architectural hardware specification assistance refer to your local ASSA ABLOY Sales Office.

A fully comprehensive, obligation free, Architectural Door Hardware specification can be prepared by Architectural Hardware Consultants.

Cleaning

Care should be taken during construction/refurbishment to ensure that paint, thinners, mortar or cement splashes are carefully removed from locks, furniture and hardware. Removal of these splashes with strong cleaning agents or scourers should be avoided.

Dirt and grime should be regularly removed with a soft and clean cloth. Do not use solvent based or abrasive cleaning agents. During cleaning, care should be taken to prevent cleaning solution from entering the cylinder keyway. Surfaces should be dried and possibly lubricated.